

Operation, installation and service instructions

## Lucid ray S | LED Indoor luminaire

Please read these instructions before installing the luminaires, using them for the first time, storage or handling.



These installation and service instructions, edition 23.06.2017  
apply to the 36 W / 120° beam angle  
Version 1.1 (2017)



## Introduction

Dear customer,

Many thanks for buying this product from us and for the trust you have placed in us.

**Please read these operating, installation and service instructions carefully before using the product.**

These instructions are aimed at suitable qualified persons (e.g. electricians, installers or engineers) tasked with installation and maintenance of this product. It applies for all versions of the Lucid ray S LED luminaires. LED luminaire in the Lucid ray S range are intended for professional use indoors.

Technical personnel must be familiar with all technical electrical directives and safety precautions, and apply these appropriately in each case.

These instructions are not suitable or intended for users and consumers without specialist technical knowledge.

For questions concerning handling the luminaire, which are not answered in these instructions, please contact:

**LIGHTS 4 Europe GmbH & Co. KG**  
Gaildorfer Str. 6  
71522 Backnang  
Germany  
Telephone +49 7191 323020  
Telefax +49 7191 323029  
Email: info@lights.de

We wish your every success with our product and hope you enjoy saving energy

## Product description & applications

The LED ceiling luminaire in the Lucid ray S range come complete with an integrated power supply / driver for operating the luminaire.





The Lucid ray S is suitable for professional use in industrial, production and warehouse buildings and for working areas.

The Lucid ray S is subject to quality checks in accordance with European standards. The luminaire stand out not only because of their modern design, but above all because of a number of special technical features, which guarantee the best possible technical performance. These include highly efficient lens optics, high-quality housing materials, constant current control, temperature monitoring, as well as lifelong regulation of luminous flux. The working temperature of -30 to 50 °C facilitates a wide range of applications.

## Labels

To help precise identification of the product, you will find information about the model and item number on the type plate. We recommend you make a note of this information so it is available if you have any questions later. This will help us handle your query more quickly.

## Symbols

	<p>By using the CE mark, the manufacturer confirms that the product conforms to the applicable, product specific European directives.</p>
	<p>None of the components in this product exceeds the permissible thresholds for use of hazardous materials in accordance with the RoHS directive 2011/65/EU</p>
	<p>The protection against accidental contact is ensured by protective insulation. All parts under power have, in addition to the operational insulation, an additional insulation. Devices of the protection class II must not be connected to a protective earth conductor - the protective earth conductor can be renounced.</p>
	<p>An electrical product marked with this symbol may not be disposed of in domestic waste.</p>
	<p>The IP protection classification system categories the level of protection which a housing for electrical devices offers against solids (e.g. dust) and liquids (water, oil etc.). IP 20 means 2 = Protection against the ingress of solid foreign bodies above a diameter of 12.5 mm; 0 = not protected against water.</p>

IG\_Lucid\_ray\_S\_Indoor\_EN\_23.06.2017\_V1.1 - Similar to illustrations, technical data are subject to change

## Installation - general safety instructions



### CAUTION - DANGER OF ELECTROCUTION

Only appropriate technical personnel may work on electrical systems. There is a risk of fatal electrocution. Before working on electrical systems and switching units, they should be removed from the power supply and secured against accidental re-connection. Before touching conductive components and cables, use appropriate equipment to confirm they are actually isolated from the power supply.

- First read the operating instructions through completely, as they contain important information for correct fitting and operation.
- Any damage caused by non-compliance with these operating instructions invalidates the warranty/guarantee! We do not accept any liability for direct or consequential damages!
- We do not accept any liability for personal or property damage caused by improper use or non-compliance with the safety instructions! In these cases, the warranty/guarantee is invalidated!
- The product may not be opened (please also read the instructions in the chapter **MAINTENANCE**).
- The light source in these luminaires is not replaceable. When the light source has reached the end of its life, the whole light must be replaced
- Do not install the product on a damp or conductive surface.
- To avoid any hazard, a damaged outer flexible lead on this light may only be replaced by the manufacturer, their representative or a comparable qualified person.
- Only install the product in switched-off mode.
- Only install the product in intended electrical systems and voltage ranges. Check and compare the information on this on the product's type plate.
- If a fault occurs, disconnect the product from the mains power supply and any other connected devices. Then ensure neither can be switched on again accidentally.
- If you cannot guarantee that the product can be operated without any danger, disconnect the product immediately from the mains power supply and any other connected devices. Once more, ensure neither can be switched on again accidentally. It is not possible to guarantee that the product can be operated without any danger when, for example, the housing or power cable is damaged, or if any foreign objects have penetrated it.
- Use suitable, approved power cables and cable connectors / clips of an adequate size. Make sure the cables sit firmly in the connectors. Any loose or exposed cables represent an extremely high risk of electric shock and fire.
- When working under roofs, on masts or any other high fitting sites, ensure you are on a solid base by using approved, certified ladders, or risers, as well as fall protection for personnel, tools and the product to be installed. Cordon off the area under the installation area adequately.
- Caution: Please consult specialists before using the luminaires in high ambient temperatures or chemically polluted environments.

## Fitting

Before beginning the assembly the supply line must be cut off from the power supply!

- Do not connect or disconnect when live!
- Installation only by a qualified electrician!

The connection of the mains connection with the mains cable is done using the terminal block supplied to the ballast unit included in the scope of delivery.

According to the illustration, the phase [L] (brown) is connected to the luminaire (black) and the neutral [N] (blue) connected to the luminaire (white).

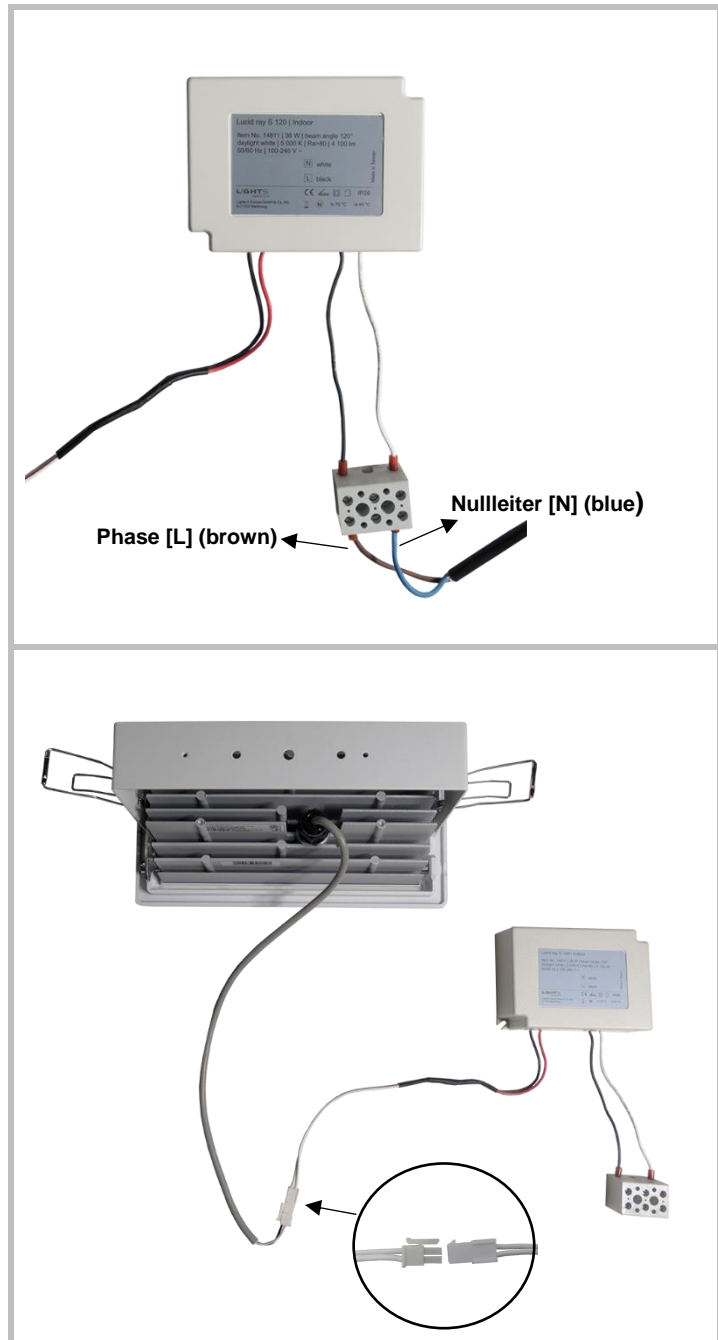

The ballast unit is connected with the low voltage lead of the ballast unit using the two-lead connection.

Hereby ensure that the plug-in connector snaps in.

## Maintenance, care and cleaning

This product requires no maintenance and so does not contain any components, which can be checked or replaced by the user. The light source in the luminaires cannot be replaced. In the event of damage, the complete light unit must be replaced. The product is fitted with appropriate safety precautions, which show unauthorised opening (safety screws). In the event of unauthorised opening of the device or removal of the type plate, any guarantee rights will be invalidated.

We recommend carrying out regular checks of the screws and the cabling, as well as a visual inspection of the housing and the diffuser for penetration by foreign bodies or superficial damage. During maintenance, the product should be disconnected from the power supply and steps take to ensure it cannot be switched on again accidentally. We recommend cleaning with a damp, soft, lint-free cloth. Do not use abrasive sponges or aggressive cleaners. During cleaning, the product should be disconnected from the power supply and steps take to ensure it cannot be switched on again accidentally.

Please note the general safety instructions in the chapter **INSTALLATION**.

## Disposal

The Lucid ray S has been developed and manufactured using high-quality materials and components. The symbol  means that this product falls under the European directive 2002/96/EG gilt. Please familiarise yourself with the relevant directives relating to the separate collection of old electric and electronic equipment in your country. Please observe the applicable regulations in your country, and do not dispose of disused equipment in domestic waste. Proper disposal of your old devices protects the environment and people from potential negative consequences and contributes towards conserving valuable resources.



## Technical data | Lucid ray S Indoor

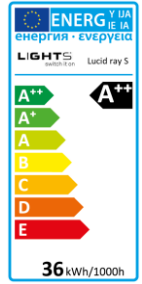

Item No.	Beam angle	Diffuser	Colour Temperature	CCT (K)	Luminous Flux / Power	EAN
<b>Lucid ray S   120° Standard Version</b>						
14811	120°	clear	daylight white	5.000 K*	4,100 lm / 36 W	4050047148117

### Product Specifications

#### General Information

Product family:	Lucid ray S
IP code:	IP 20
EU 2013 label classification:	A++
Application / Ambient Temperature:	-30°C to +50°C
Material heat sink:	Aluminium
Certification	CE
LED Life time prediction:	> 60,000 h
Dimensions:	229.5 x 139.5 x 115 mm
Net weight:	2.100 g
Assembly:	ceiling suspension

#### Photometric properties

Optics:	120° (additional beam angle on request)
Colour Rendering Index:	Ra > 80
Luminous efficacy:	up to 114 lm/W

#### Electrical specifications

Power:	36 W
Mains Voltage:	230 V ~
Frequency:	50 Hz
Current consumption:	0.22 A
Dimming:	on request
Protection class:	II
Driver efficiency:	> 92% eff.

#### Dimensions

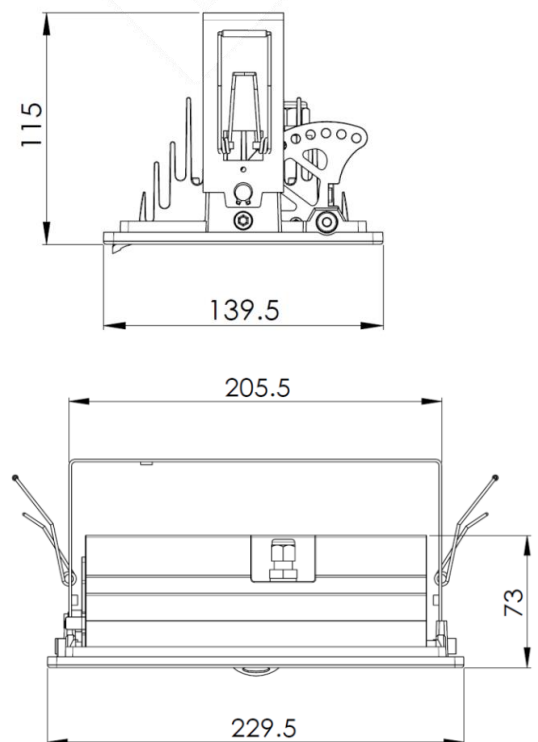

IG\_Lucid\_ray\_S\_Indoor\_EN\_23.06.2017\_V1.1 - Similar to illustrations, technical data are subject to change

## Guarantee period

1. The guarantee period is 2 years, where an extension to the guarantee was not agreed for an extra fee at the time of purchase. This starts when the product is delivered to the end user. Any claims under guarantee must be made in writing.
2. To validate a guarantee claim, the receipt must be presented, on which the delivery or purchase data is clearly visible. In the event of a claim under guarantee, the device should be sent to your specialist retailer or to the following address:

**LIGHTS 4 Europe GmbH & Co. KG** (in the following "LIGHTS")  
Gaildorfer Str. 6  
D-71522 Backnang  
Email: info@lights.de

All design, material and manufacturing faults are covered by the guarantee.

3. The guarantee excludes any faults or deficiencies relating to the following points:
  - a) Failure to follow the operating and safety instructions.
  - b) Natural wear and tear.
  - c) External factors such as transport damage, damage caused by impact, shock or over heating, as well as chemical or electro-chemical factors such as those caused by water, acids or improper use.
  - d) Repairs or alterations carried out by non-authorized third parties.
  - e) Use of unsuitable accessories.
  - f) Unauthorised opening of the housing
  - g) Removal of the type plate
4. The following are also excluded: Damage caused by improper handling, fitting or maintenance of the luminaires (see fitting instructions), damage caused by excessive force, fire, vandalism or accidental damage.
5. *LIGHTS* will resolve any faults within the guarantee period in consultation with the specialist retailer. This will take the form either of a repair or replacement of the component in question. Parts removed become the property of *LIGHTS*. Any further claims, of any kind, in particular claims for damages are excluded.
6. The following are excluded from the guarantee:
  - a) Costs for removal / fitting of the faulty or repaired luminaires
  - b) Costs for sending back the faulty luminaires

LED luminaire from *LIGHTS* are subject to ongoing development with regard to technical progress. For this reason, in the event of a repair or a replacement, the design of the repaired or replaced luminaires may not correspond to the original design of the luminaire subject to the claim, but it may be of equal or higher quality in terms of its properties and features. *LIGHTS* reserves the right to change guarantee periods, fixed price arrangements and conditions without prior notice. However, guarantees with a valid registration before the time of the change remain unaffected by this. *LIGHTS* reserves the right to make the final decision with regard to the validity of a guarantee claim.

## Legal notices

These operating instructions contain the information required for appropriate use.

Knowledge and observance contained in these operating instructions are a condition of safe use and for safety in operation. These operating instructions cannot consider every possible application. The LED luminaire is intended for use indoors.

In addition, we would like to point out that the contents of these operating instructions are not part of, or represent a change to, a prior or existing agreement, consent or legal relationship. The operating instructions contain information, which is copyright protected. Production of photocopies, or translations into another language, are not allowed without prior written permission from LIGHTS 4 Europe GmbH & Co. KG - Germany.

LED-Luminaire and light sources from LIGHTS 4 Europe GmbH & Co. KG are subject to ongoing development with regard to technical progress.

**LIGHTS 4 Europe GmbH & Co. KG**

Gaildorfer Str. 6  
71522 Backnang  
Germany

Telephone +49 7191 323020  
Telefax +49 7191 323029  
Email: [info@lights.de](mailto:info@lights.de)

We wish your every success with our product and hope you enjoy saving energy.